

AUTHORISED ITEMS for WATER RETICULATION SYSTEM

MAINTENANCE

***THESE ITEMS ARE NOT AUTHORISED FOR USE IN NEW
INFRASTRUCTURE APPLICATIONS.***

THE ITEMS ARE FOR USE IN MAINTENANCE APPLICATIONS ONLY.

AUTHORISED ITEMS for WATER RETICULATION SYSTEM

Document Update Information

Date	Change Type	Page Number(s)	Details
1 Jul 07	Revision 01	1-10	Moved from Water Connections Section <ul style="list-style-type: none"> • Brass connector range • Inlet and Outlet Risers
15 Jan 09	Revision 02	General	Standards Unit details changed
		18	Street Box Concrete Support Slab added
8 Dec 09	Revision 03	19	Street Box Assembly Lightweight added

AUTHORISED ITEMS for WATER RETICULATION SYSTEM

SA Water Product Description

Adaptor - Brass Tube x BSP F w/nut

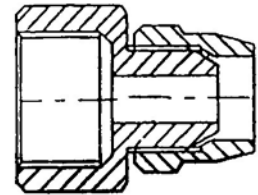

Alternative Description

Adaptor - Tube to Socket

Size Tube x Socket	SA Water Stock No.	Autotherm	Wadham
18 x 15	4730-1507	*	
18 x 20	4730-1902	*	*
20 x 15	4730-1906	*	*
20 x 20	4730-1509	*	*

SA Water Product Description

Adaptor - Brass Tube x BSP M w/nut

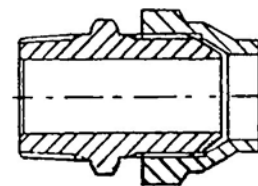

Alternative Description

Adaptor - Tube to Nipple

Size Tube x Socket	SA Water Stock No.	Autotherm	Wadham
18 x 15	4730-1903	*	
20 x 15	4730-1905	*	*
20 x 20	4730-1904	*	*

AUTHORISED ITEMS for WATER RETICULATION SYSTEM

SA Water Product Description

Coupling - Brass Hex BSP

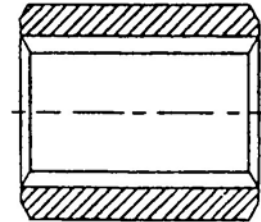

Alternative Description

Item	SA Water	Autotherm	Wadham
Nominal Bore	Stock No.		
15	4730-1511	*	
20	4730-1513	*	*

SA Water Product Description

Coupling - Tube Brass BSP

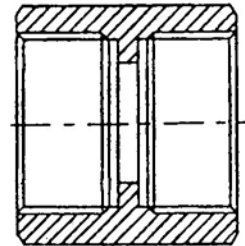

Alternative Description

Item	SA Water	Autotherm	Wadham
Nominal Tube	Stock No.		
25	4730-1456	*	*
32	On Request	*	
40	4730-4921	*	
50	4730-4920	*	

AUTHORISED ITEMS for WATER RETICULATION SYSTEM

SA Water Product Description

***Nipple - Tube Brass Hex BSP
 -Tube W/Nut***

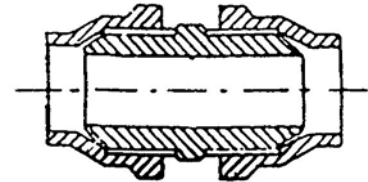

Alternative Description
Coupling Nipple

Item Nominal Tube	SA Water Stock No.	Autotherm	Wadham
18	4730-1505	*	
20	4730-1506	*	*

SA Water Product Description

***Nipple - Main Tapping
 (Main Cock Substitute)***

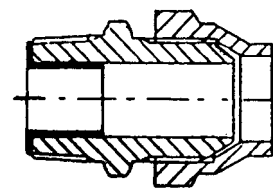

Alternative Description
Tapping Nipple

Size Nom. Pipe Tube (mm)	SA Water Stock No.	Autotherm
20	4730-4937	*

AUTHORISED ITEMS for WATER RETICULATION SYSTEM

SA Water Product Description

Coupling Tube- Brass BSP F W/Nuts

Alternative Description

Coupling Tube Inverted Nuts

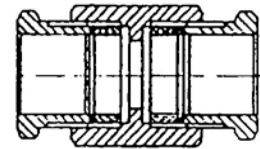

Item Nominal Tube	SA Water Stock No.	Autotherm	Wadham
25	4730-1396	★	★
32	4730-1397	★	
40	4730-1398	★	
50	4730-1399	★	

SA Water Product Description

Nipple - Brass BSP Hex

Alternative Description

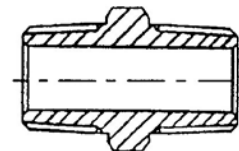

Item Nominal Tube	SA Water Stock No.	Autotherm	Wadhams
10	4730-1495	★	
15	4730-1392	★	★
20	4730-1395	★	★
25	4730-1496	★	★
32	4730-1497	★	★
40	4730-1394	★	★
50	4730-1498	★	★

AUTHORISED ITEMS for WATER RETICULATION SYSTEM

SA Water Product Description

Nut - Tube Coupling Brass BSP Tube

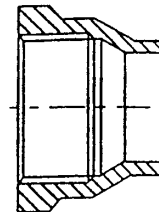

Alternative Description

Flared nut

DN Tube	SA Water Stock No.	Autotherm	Wadham
18	4730-1510	★	
20	4730-1402	★	★

SA Water Product Description

Inverted Nut - Tube Coupling Brass BSP

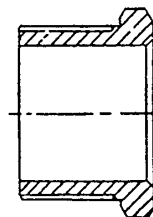

Alternative Description

DN Tube	SA Water Stock No.	Autotherm
25	4730-1460	★
32	4730-1461	★
40	4730-1462	★
50	4730-1463	★

AUTHORISED ITEMS for WATER RETICULATION SYSTEM

SA Water Product Description

Plug - Brass BSP Hex

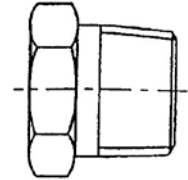

Alternative Description

DN Tube	SA Water Stock No.	Autotherm	Wadham
10	4730-1491	★	
15	4730-1492	★	★
18	4730-1493	★	
20	4730-1494	★	★

SA Water Product Description

***Sleeve Compression
(Neo-Rubber)***

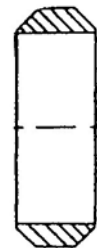

Note : Used as coupling sealing rings

Alternative Description

Seal Sleeve

DN Pipe	SA Water Stock No.	Autotherm
25	4730-1406	★
32	4730-1407	★
40	4730-1408	★
50	4730-1409	★

AUTHORISED ITEMS for WATER RETICULATION SYSTEM

SA Water Product Description

Reducer - BSP Hex M-M

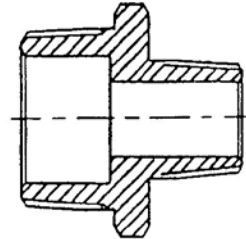

Alternative Description

Reducer Nipple

DN Pipe	SA Water Stock No.	Autotherm	Wadhams
15 x 10	4730-1481	★	★
20 x 15	4730-1393	★	★
25 x 20	4730-1482	★	★
32 x 20	4730-1483	★	★
32 x 25	4730-1484	★	★
40 x 25	4730-1485	★	★
40 x 32	4730-1486	★	★
50 x 25	4730-1487	★	★
50 x 32	4730-1488	★	★
50 x 40	4730-1489	★	★

SA Water Product Description

Reducer - BSP Oct M-M

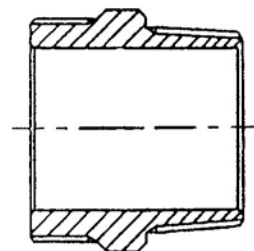

Alternative Description

Reducer Nipple

DN Tube	SA Water Stock No.	Autotherm	Wadhams
57 x 50	4730-1389	★	★

AUTHORISED ITEMS for WATER RETICULATION SYSTEM

SA Water Product Description

Riser Inlet Assembly
- With Valve 20 mm
for Copper Water Connections

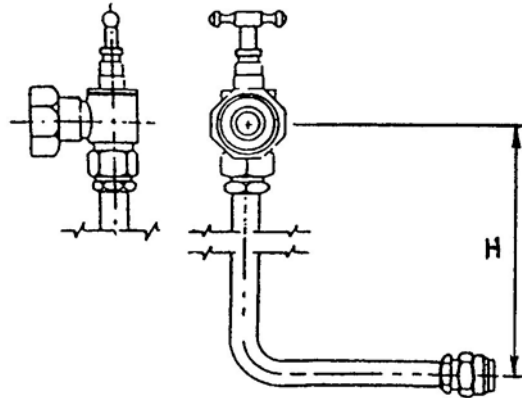

Alternative Description

DN Tube x Height	SA Water Stock No.	Autotherm	Wadhams
20 x 305	4730-1914	★	★
20 x 533	4730-1911	★	★

SA Water Product Description

Riser Inlet Assembly
- With 20 mm Angle Valve
for 25mm PE Water Connections

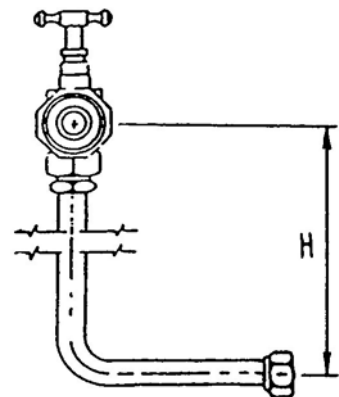

Alternative Description

DN Tube x Height	SA Water Stock No.	Autotherm	Wadhams
20 x 305	4730-4938	★	★
20 x 533	4730-4936	★	★

AUTHORISED ITEMS for WATER RETICULATION SYSTEM

SA Water Product Description

***Riser Inlet Assembly
 - With Valve 20 mm
 for PE Transition Couplings***

NOTE :

This riser is for maintenance purposes only and is for use with PE to Copper Transition Couplings (see page 6) in difficult to access locations.

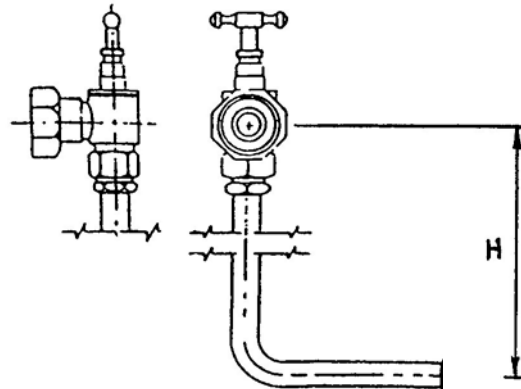

Alternative Description

DN Tube x Height	SA Water Stock No.	Autotherm	Wadhams
20 x 305	4730-5116	★	★
20 x 533	4730-5115	★	★

SA Water Product Description

***Riser Outlet Assembly
 - Special***

NOTE : This is a replacement item for the old Galvanised Outlet Riser.

Alternative Description

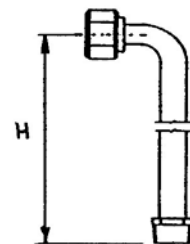

DN Tube x Height	SA Water Stock No.	Autotherm
20 x 305	4730-5114	★

AUTHORISED ITEMS for WATER RETICULATION SYSTEM

SA Water Product Description

Union Pipe DR Brass Pipe

Alternative Description
Union Tube to Pipe

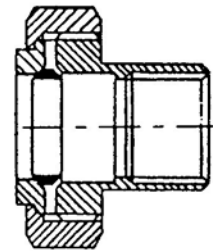

DN Pipe	SA Water Stock No.	Autotherm
20	4730-4018	★
25	4730-4013	★

SA Water Product Description

Union Brass Flat Gasket Seat BSP M/F

Alternative Description
Union Pipe Male/Female Flat Gasket Seal

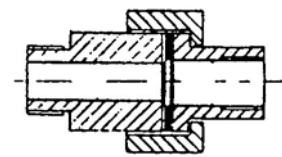

Nom. Size DN x dn	SA Water Stock No.	Autotherm
10 x 6	4730-1465	★

AUTHORISED ITEMS for WATER RETICULATION SYSTEM

SA Water Product Description

Valve - Angle Valve Head Assembly

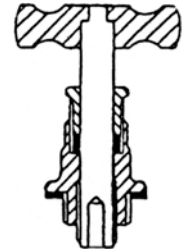

Alternative Description

Size Nom. Pipe (mm)	SA Water Stock No.	Autotherm	Wadham
15	4820-0856	★	★
20	4820-0857	★	★

SA Water Product Description

***Valve - Replacement
 Fireplug Head Assembly
 - Original EWS Style***

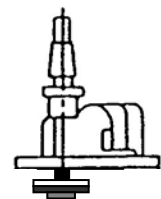

Alternative Description

***Cover Assembly CI Fireplug
 Fireplug – Air valve Head Assy***

Nom. Size DN	SA Water Stock No.	Tyco Water	Leah Nominees
80mm (1.6 MPa only)	4210-0055	★	★

Note: Individual components may be supplied as individual items.

AUTHORISED ITEMS for WATER RETICULATION SYSTEM

SA Water Product Description

Riser Inlet Assembly
- With Valve 20 mm
for Copper Water Connections

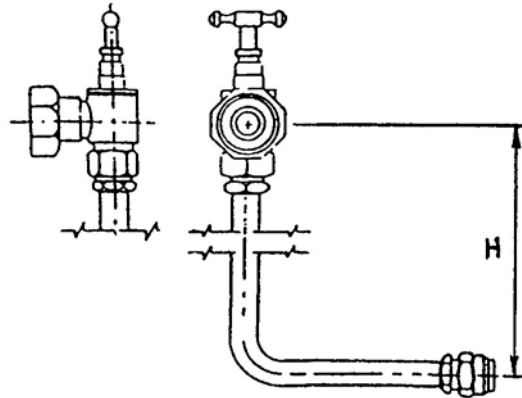

Alternative Description

DN Tube x Height	SA Water Stock No.	Autotherm	Wadhams
20 x 305	4730-1914	★	★
20 x 533	4730-1911	★	★

SA Water Product Description

Riser Inlet Assembly
- With 20 mm Angle Valve
for 25mm Polyethylene Water Connections

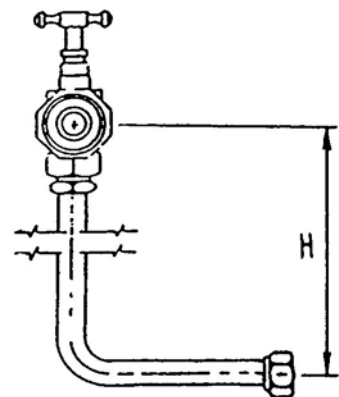

Alternative Description

DN Tube x Height	SA Water Stock No.	Autotherm	Wadhams
20 x 305	4730-4938	★	★
20 x 533	4730-4936	★	★

SA Water Product Description

Riser Inlet Assembly

AUTHORISED ITEMS for WATER RETICULATION SYSTEM

**- With Valve 20 mm
for Copper Water Connections**

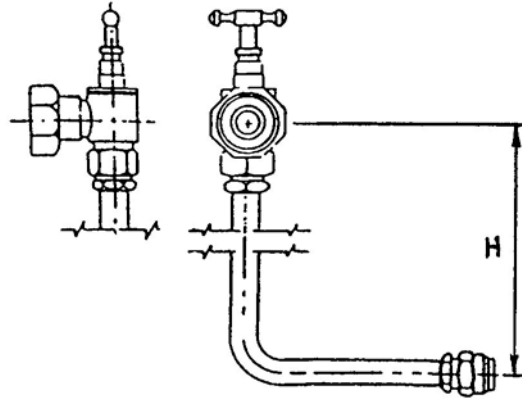

Alternative Description

DN Tube x Height	SA Water Stock No.	Autotherm	Wadhams
20 x 305	4730-1914	★	★
20 x 533	4730-1911	★	★

SA Water Product Description

**Riser Inlet Assembly
- With 20 mm Angle Valve
for 25mm Polyethylene Water Connections**

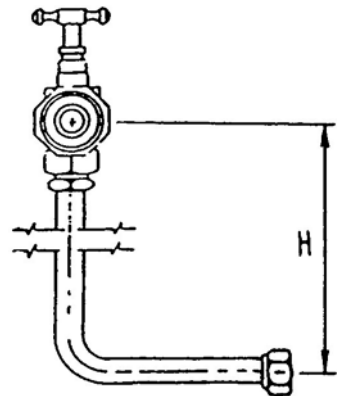

Alternative Description

DN Tube x Height	SA Water Stock No.	Autotherm	Wadhams
20 x 305	4730-4938	★	★
20 x 533	4730-4936	★	★

SA Water Product Description

Dummy Fireplug Valve

AUTHORISED ITEMS for WATER RETICULATION SYSTEM

(With Nut and Rubber Washer)

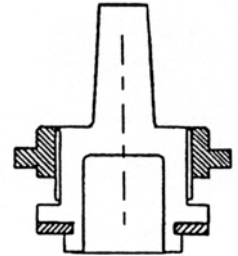

Alternative Description

Water Stop for Fireplug

DN Pipe	SA Water Stock No.	Autotherm	Leahy Nominees
63	4210-0033		★

SA Water Product Description

Stainless Steel Repair Clamps

NOTE :

Only to be provided in the full wrap clamp style and be used on CICL, DICL, PVC and AC Mains only.
 # Tyco (Wang) Clamps may also incorporate a 20, 25, 40 or 50mm BSP tapped boss.

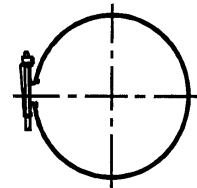

Alternative Description

Nom. Size DN	Crevet Iplex	Tyco (Wang) K3 Clamp #
80	★	★
100	★	★
150	★	★
200	★	★
250	★	★
300	★	★
375	★	★

AUTHORISED ITEMS for WATER RETICULATION SYSTEM

SA Water Product Description

***Multi Fit Mechanical Couplings
(FBE Coated)***

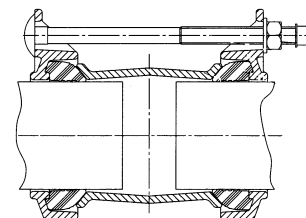

Straight Coupling

Alternative Description

Multigib Coupling (Long Sleeve preferred)

Ψ Supa Coupling

β Supa Stepped Coupling

φ Supa Adaptor Flange

Notes:

- *These products have FBE coated bolts and have a life expectancy of 25 (+) years and are to be used only on AC and CICL pipe materials.*
- *Bitumen coated fittings are to be completely wrapped in Petrolatum tape.*
- *Couplings to be installed in accordance with Manufacturers Specification.*
- *Couplings with 316 Stainless Steel Bolts and FBE coatings are the preferred product.*

Nom. Size DN	Straight Coupling				
	Helden	AVK Model 601 Trim 4112 Ψ	Talbot	Viking Johnson Maxifit	Tyco Water #
40	★	★	★	★	★
50	★	★	★	★	★
65	★	★	★	★	★
80	★	★	★	★	★
100	★	★	★	★	★
125	★	★	★	★	★
150	★	★	★	★	★
200	★	★	★	★	★
250	★	★	★	★	★
300	★	★	★	★	★

Note:

1. Larger sizes are available from some suppliers

(Continued)

AUTHORISED ITEMS for WATER RETICULATION SYSTEM

Multi Fit Mechanical Couplings (continued)

(FBE Coated)

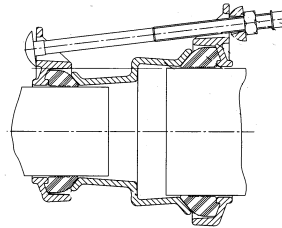

Stepped Coupling

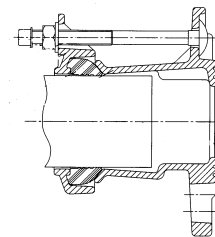

Adaptor Flange

Alternative Description

β Supa Stepped Coupling

φ Supa Adaptor Flange

- *These products have FBE coated bolts and have a life expectancy of 25 (+) years and are to be used only on AC and CICL pipe materials.*
- *Bitumen coated fittings are to be completely wrapped in Petrolatum tape.*
- *Couplings to be installed in accordance with Manufacturers Specification.*
- *Couplings with 316 Stainless Steel Bolts and FBE coatings are the preferred product.*

Nom. Size DN	Stepped Couplings		Adaptor Flange	
	Viking Johnson Maxistep	AVK Model 602 Trim 4112 β	Viking Johnson Maxidaptor	AVK Model 603 Trim 4112 φ
40		*		*
50	*	*	*	*
65	Full range of size combinations	Full range of size combinations	Full range of size combinations	*
80				Full range of size combinations
100				Full range of size combinations
125	*	*	*	*
150	*	*	*	*
200	*	*		*
250	*	*		*
300	*	*		*

AUTHORISED ITEMS for WATER RETICULATION SYSTEM

SA Water Product Description

PE Transition Couplings

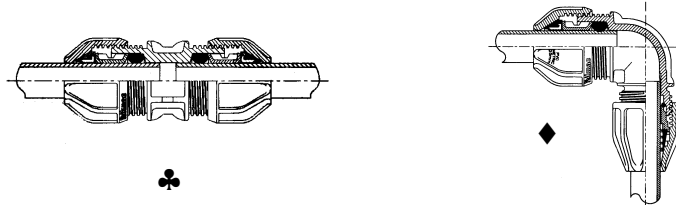

Alternative Description

Item	Sizes	Philmac	Plasson
Copper to PE - Straight Joiner	As available	★	★
◆ Copper to PE - Elbows	As available	★	★
♣ Copper to Copper - Double Ended Repair Coupling	As available	★	★

SA Water Product Description

Socket Leak Clamps

NOTE : To be installed in accordance with Manufacturers specifications. Complete fitting to be wrapped in Petrolatum tape.

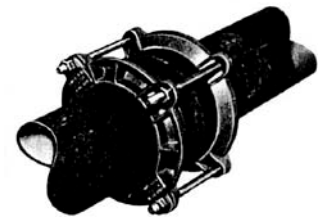

Alternative Description

Joint Leak Clamps

Nom. Size DN	Wang
50	★
80	★
100	★
150	★
200	★
250	★
300	★

Sizes available up to 1.2 metres diameter

AUTHORISED ITEMS for WATER RETICULATION SYSTEM

SA Water Product Description ***Street Box Assembly - Packing Segments***



Alternative Description

Item	SA Water Stock No.	Bianco PCP	Leah Nominees
Packing Segments			
25 thick - Concrete	5680-0196	★	
38 thick - Concrete	5680-0197	★	
50 thick - Concrete	5680-0198	★	
75 thick - Concrete	5680-0199	★	
100 thick - Concrete	5680-0200		
Thin Packing Segments			
Moulded Plastic (160 x 60 x 6) 10 Segments per full ring	5680-0313		★

SA Water Product Description ***Street Box Support Slab- Heavy Duty***

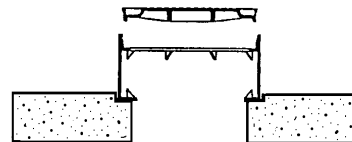

Item	SA Water Stock No.	Bianco PCP	Cooke Pre Cast (CPC)
<u>Type 1 Support - Slab Type</u>			
Concrete slab 800 x 800 x 125 thick	5680-0051	★	★

AUTHORISED ITEMS for WATER RETICULATION SYSTEM

SA Water Product Description

Street Box Assembly - Lightweight

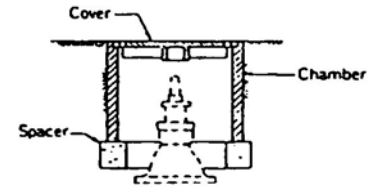

Alternative Description
Poly Street Box

Item	SA Water Stock No.	Bianco (PCP)	Tyco Water	Vinidex	WASA (Cooke Pre Cast)	Webforge
Cover (Two Piece Lid)	5680-0060	*	*		*	*
Polyethylene Chamber #	5680-0379			*		
Spacer						
600 dia x 75 thick	5680-0072	*			*	
600 dia x 140 thick	5680-0049	*			*	

This Chamber is **NOT** designed for road use

AUTHORISED ITEMS for WATER RETICULATION SYSTEM

SA Water Product Description

Field Welding Services

Alternative Description

Authorised

- Water Engineering Technologies (SA Water Berri and Crystal Brook workshops)
 - Ottoway Engineering
 - Lincoln Engineering
 - N&A Mobile Welding Services
 - Contract Engineering SA
-

AUTHORISED ITEMS for WATER RETICULATION SYSTEM

INDEX

Adaptor
 Brass Tube x BSP F w/nut 1
 Brass Tube x BSP M w/nut 1

Coupling
 Brass Hex BSP 2
 Tube Brass BSP 2
 Tube Brass BSP F w/nuts 4

Dummy Fireplug Valve 13

Field Welding Services 20

Inverted Nut
 Tube coupling brass BSP 5

Multi Fit Mechanical Couplings 15, 16

Nipple
 Brass BSP Hex 4
 MainTapping (Main Cock Substitute) 3
 Tube brass Hex BSP w/nut 3

Nut
 Tube Coupling brass BSP tube 5

PE Transition Couplings 17

Plug
 Brass BSP Hex 6

Reducer
 BSP Hex M-M 7
 BSP Oct M-M 7

Riser
 Inlet Assembly 20mm Copper 8, 12
 Inlet Assembly 20mm for 25mm Polyethylene 8, 12, 13
 Inlet Assembly 20mm for PE Transition Coupling 9
 Outlet Assembly Special 9

Sleeve Compression 6

Socket Leak Clamps 17

Stainless Steel Repair Clamps 14

Street Box Assembly
 Packing Segments 18

Street Box Support Slab
 Heavy Duty 18

Street Box Assembly
 Lightweight Duty (Polly) 19

Union Brass Flat Gasket Seat BSP M/F 10

Union Pipe DR Brass Pipe 10

Valve
 Angle Valve Head Assembly 11
 Replacement Fireplug Head Assy Original EWS Style 11